

2008085

Replacing the Berchtold D850 Extension Stop

PARTS LIST

- Screwdriver
- 3 screws
- Replacement Extension Stop

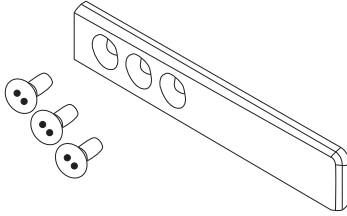

Step One:

Locate the bent extension stop attached to the Berchtold D850.



Step One

Step Two:

Rotating counter-clockwise, remove the three screws with the provided screwdriver.



Step Two

Replacing Berchtold D850 Extension Stop

Step Three:

Discard the damaged extension stop and damaged screws (if any).

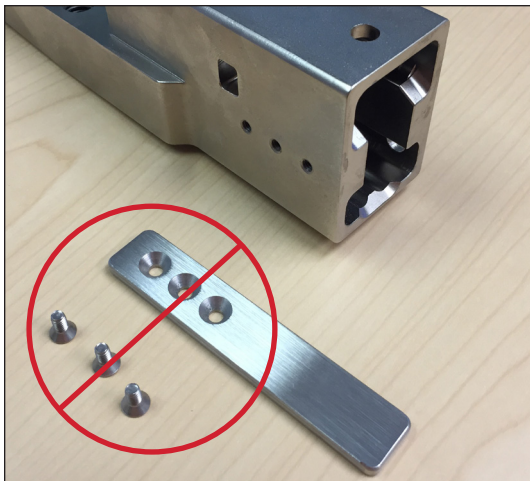

Step Three

Step Four:

Attach the replacement extension stop to the Berchtold D850 by screwing the three screws into position, rotating clockwise with the provided screwdriver. Ensure all three screws have been tightened.



Step Four



440 Church Road
Avondale, PA 19311 USA
www.Qfix.com

+1 610.268.0585 / 800.526.5247

+1 610.268.0588 / 800.831.8174

sales@Qfix.com