



positioning
patients for life.®

ADDENDUM

RT-4546AA-01 & RT-4546AW-01

Arm & Wrist Supports

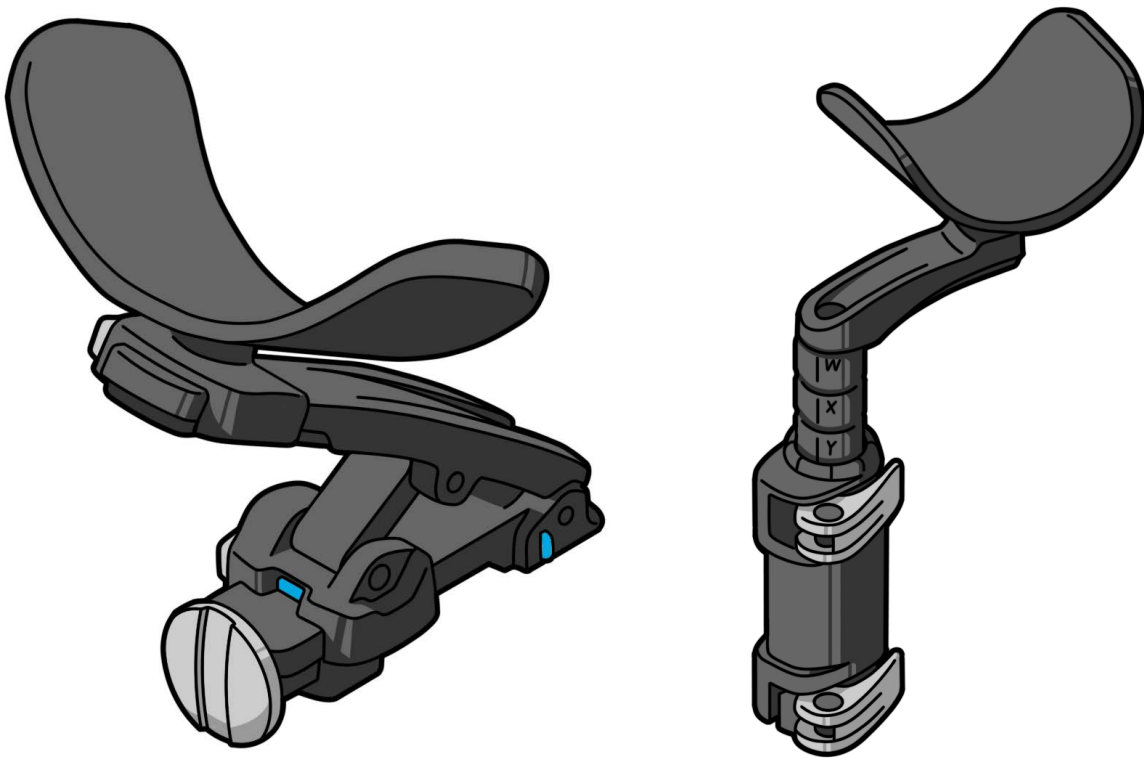

GENERAL PRECAUTIONS

WARNING STATEMENTS

! WARNING ! NO MODIFICATION OF THIS EQUIPMENT IS ALLOWED. IF ANY PART OF THIS DEVICE EXPERIENCES A CATASTROPHIC LOAD, APPEARS DAMAGED OR FUNCTIONS IMPROPERLY, DISCONTINUE USE IMMEDIATELY AND CONTACT QFIX AT +1 484-720-6054 OR TECHSUPPORT@QFIX.COM.

! WARNING ! DO NOT ALLOW PATIENT TO ADJUST POSITION USING THE ARM AND WRIST SUPPORTS.

! WARNING ! NEVER LIFT OR CARRY THE DEVICE BY HOLDING THE ARM OR WRIST SUPPORTS.

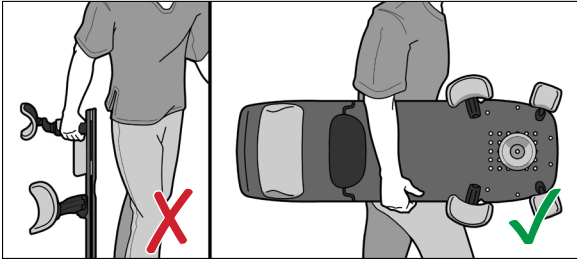

TRAPPING ZONES

- Trapping zones may occur when adjusting the Arm Support or Wrist Support height.
- Trapping zones may occur when adjusting the Arm Support or Wrist Support angle.

MRI SAFETY INFORMATION

 Non-Clinical testing has demonstrated the Arm and Wrist Supports are MR Conditional. These devices may be used in an MR system meeting the following conditions:

- The Arm and Wrist Supports may be placed in the bore of an MR system having a static Magnetic field of 1.5T or less.
- The Arm and Wrist Supports must be used with the MR Safe version of the Access Supine (RT-4546MRI) in accordance with its intended use prior to scanning.
- The MR Safe version of the Access Supine (RT-4546MRI) is clearly labeled with the following symbol:



EC REP	Advena Limited Tower Business Centre, 2nd Flr Tower Street, Swatar, BKR 4013 Malta	 Made in the USA by Qfix 440 Church Rd, Avondale, Pennsylvania, USA +1 610-268-0585 www.Qfix.com
--------	---------------------------------------------------------------------------------------------	----------------------------------------------------------------------------------------------------------------------------------------------------------------------------------------------------------------------------------

Access, MR Secure, kVue, VacQFix, and ArmShuttle Elite are trademarks of Qfix.

OPERATING INSTRUCTIONS

SETUP

ARM SUPPORT

1. To attach the Arm Support loosen the knob and insert into one of the two locations (marked with “X” and “Y”). Tighten knob to lock Arm Support onto the Patient Surface. (Fig. 1)
2. To adjust the rotation of the Arm Support, loosen knob and rotate the Arm Support to the desired location and tighten the knob. (Fig. 2)

! CAUTION ! DO NOT OVERTIGHTEN.

3. To adjust the height, depress the button located on the height slider and slide along the arm, releasing the button once in the desired position. (Fig. 3)
4. To adjust the length of the arm, depress the button located on the length slider and slide along the arm, releasing the button once in the desired position. (Fig. 4)

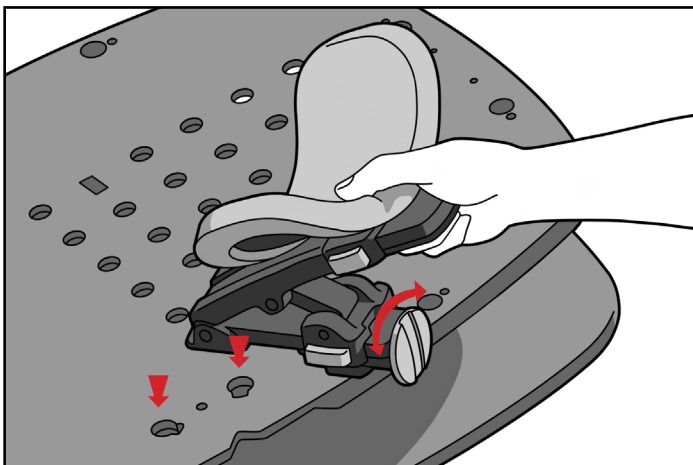

FIG. 1

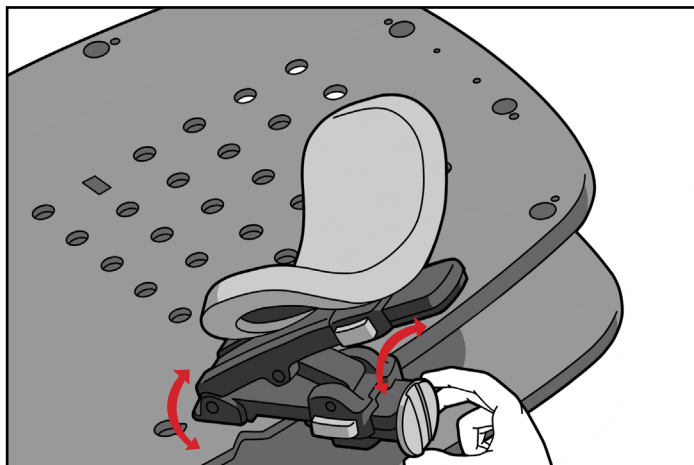

FIG. 2

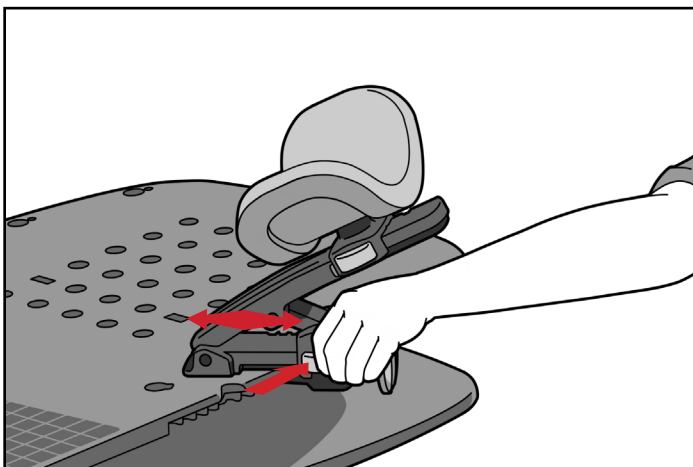

FIG. 3

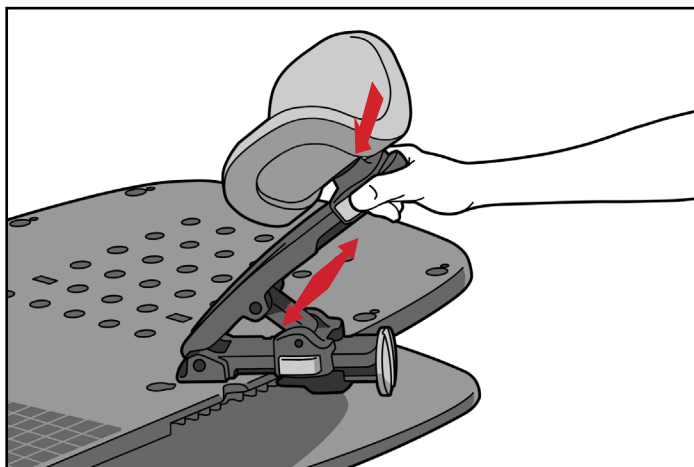

FIG. 4

REMOVAL

To remove Arm Support, loosen the knob, rotate the Arm Support so that it lines up with the notch at the side of the Patient Surface and pull the Arm Support out of the holes in the Patient Surface.

OPERATING INSTRUCTIONS

SETUP

WRIST SUPPORT

1. To attach the Wrist Support, align both pegs on the bottom of the Wrist Support with the two corresponding holes in the Patient Surface. (Fig. 5)
2. Close lower lever to lock in place. (Fig. 6)
3. To raise or lower the cup of the Wrist Support, open the upper lever. Raise, lower, or rotate the cup into desired position and close the upper lever. (Fig. 7 and Fig. 8)

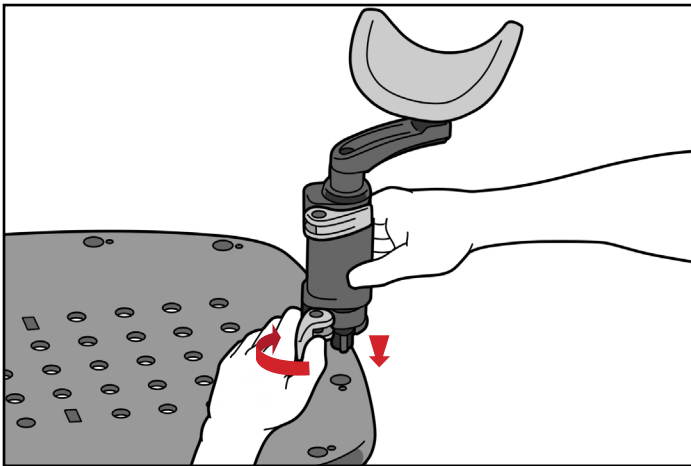

FIG. 5

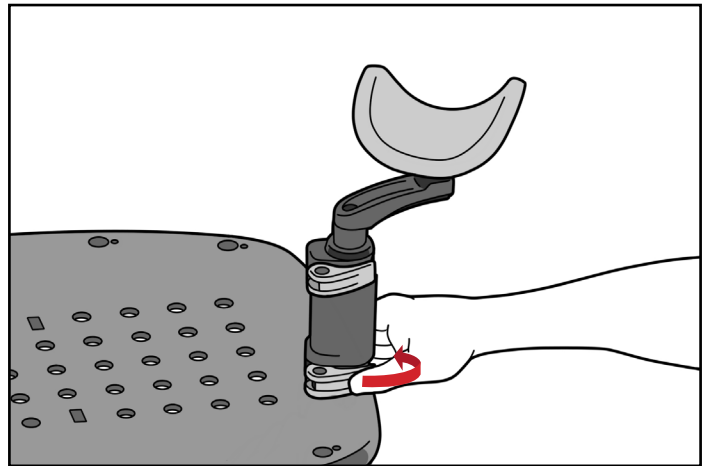

FIG. 6

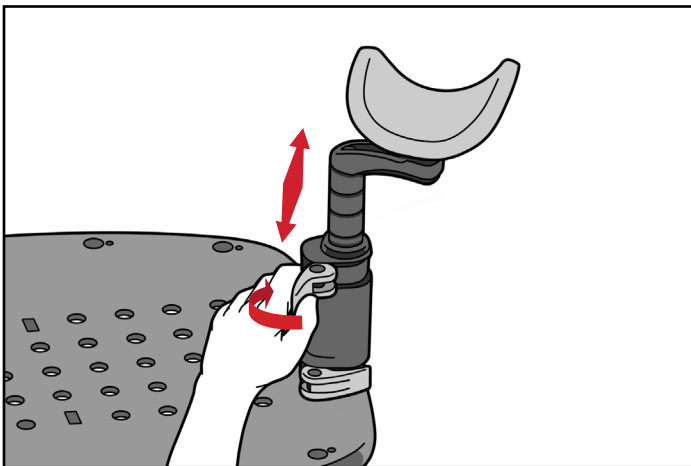

FIG. 7

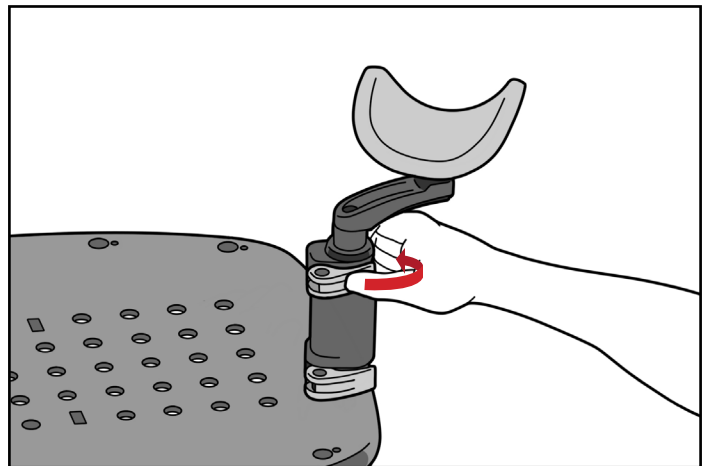

FIG. 8

REMOVAL

To remove Wrist Support, open the lower lever and pull the Wrist Support out of the holes in the Patient Surface.

SETUP SHEET

RT-4546: Access Supine Breast & Lung, RT-4546MRI: Access Supine MR Breast & Lung,
RT-4546-01: Access Supine Breast, or RT-4546-02: Access Supine Breast & Lung without Grid

Patient Name:

Patient ID #:

Setup by:

Physician:

Date:

Comments:

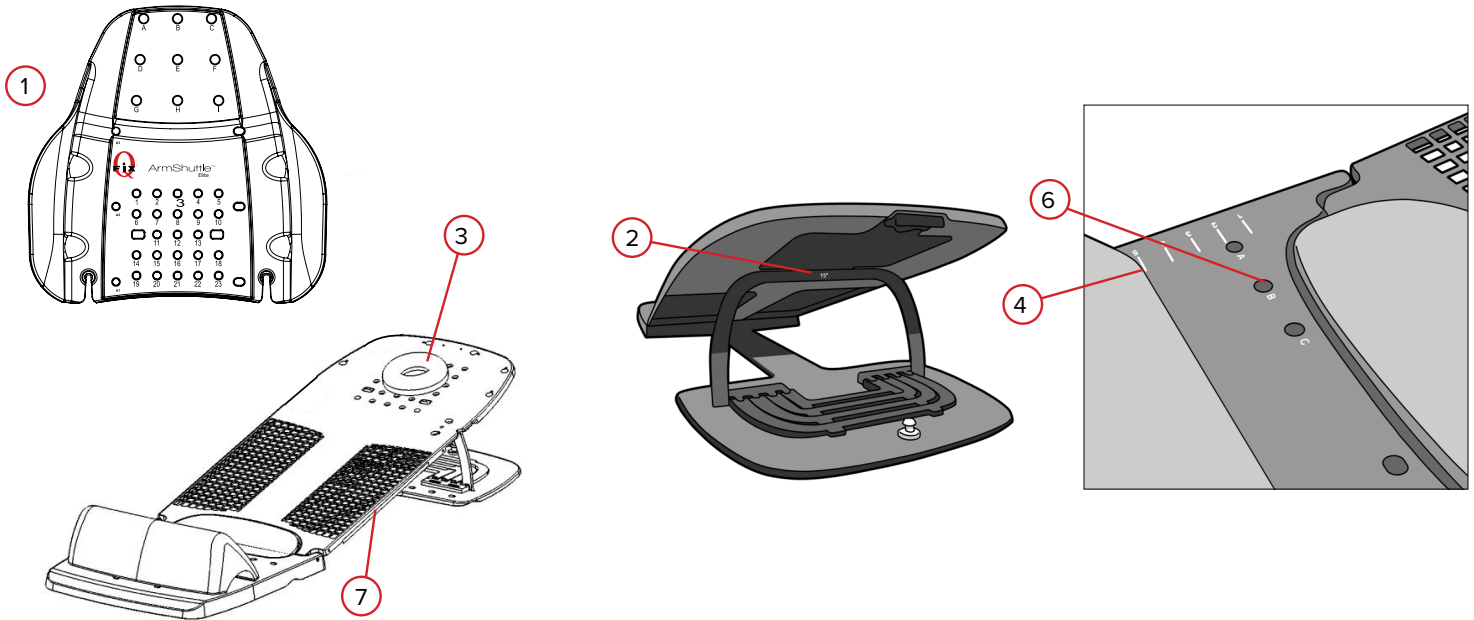

1. Used with the ArmShuttle: **Yes** **No**
2. Angle of Patient Surface (select one): **0°** **5°** **7.5°** **10°** **12.5°** **15°** **20°** **25°**
3. Location of head rest (number 1–28):
4. Is a Bottom Stopper used? **Yes** **No** If yes, what setting? (number 1–8)
5. Indexed to simulation or treatment table? **Yes** **No** If yes, Index notch setting
6. Locating bar pin location (select one): **A** **B** **C**
7. Side marking laser location:

SETUP SHEET

RT-4546: Access Supine Breast & Lung, RT-4546MRI: Access Supine MR Breast & Lung,
RT-4546-01: Access Supine Breast, or RT-4546-02: Access Supine Breast & Lung without Grid

Patient Name:

Patient ID #:

Setup by:

Physician:

Date:

Comments:

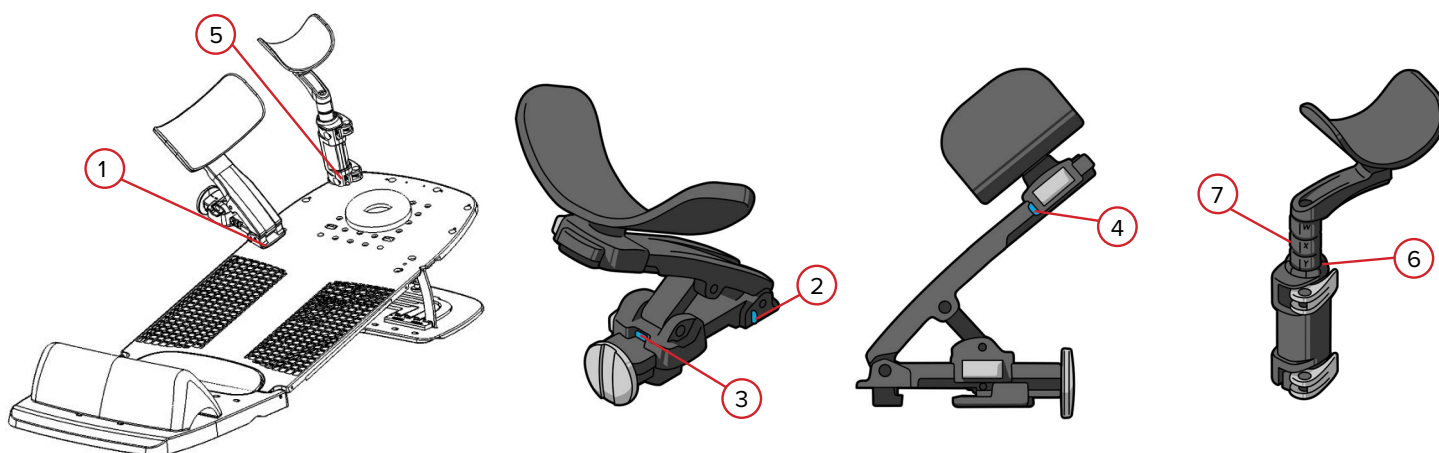

1. Location of Arm Supports (select one)—Patient's Left: **X** **Y** Patient's Right: **X** **Y**

2. Angle of Arm Supports:

Patient's Left:	-30°	-15°	0°	15°	30°
Patient's Right:	-30°	-15°	0°	15°	30°

3. Height of Arm Supports (number 1–8): Patient's Left Patient's Right

4. Length of Arm Supports (select one): Patient's Left: **A** **B** **C** Right Side: **A** **B** **C**

5. Location of Wrist Supports (letter from A–F): Patient's Left Patient's Right

6. Angle of Wrist Supports:

Patient's Left:	0°	45°	90°	135°	180°	225°	270°	315°
Patient's Right:	0°	45°	90°	135°	180°	225°	270°	315°

7. Height of Wrist Supports (letter from W–Z): Patient's Left Patient's Right



440 Church Road
Avondale, PA 19311 USA
www.Qfix.com

+1 610.268.0585 / 800.526.5247

+1 610.268.0588 / 800.831.8174

sales@Qfix.com