



positioning  
patients for life.®

# PRODUCT GUIDE & USER MANUAL

RT-4551KVE kVue™ EDGE™ Couch Top

RT-4551KVCL-V kVue™ Calypso® Couch Top

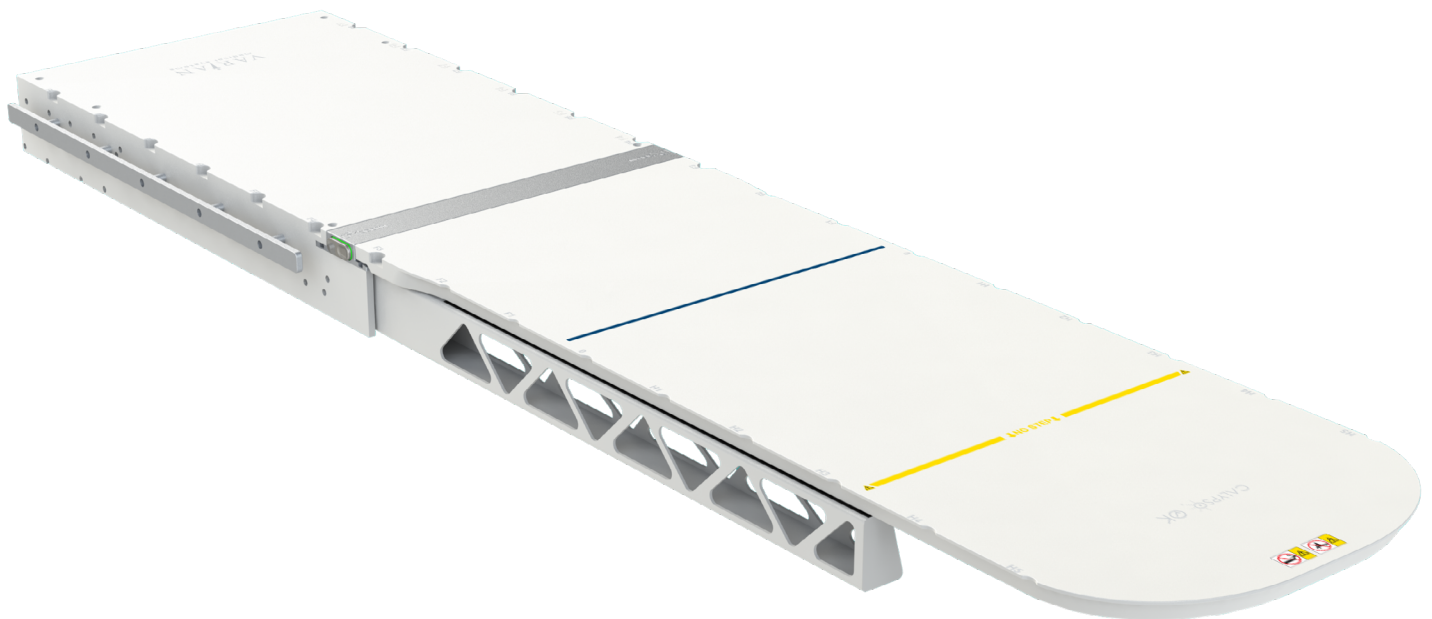



EC	REP	Advena Limited Tower Business Centre, 2nd Flr Tower Street, Swatar, BKR 4013 Malta	 Made in the USA Qfix 440 Church Rd, Avondale, Pennsylvania, USA +1 610-268-0585 <a href="http://www.Qfix.com">www.Qfix.com</a>
----	-----	---	---

kVue and OneTouch are trademarks of Qfix.

Exact®, ETR®, Calypso® and Beacon® are registered trademarks of Varian Medical Systems.

TrueBeam and EDGE are trademarks of Varian Medical Systems.

Precise® is a registered trademark of Elekta AB.

ZXT and TXT are trademarks of Siemens AG.

Cidex® is a registered trademark of Johnson & Johnson

Clorox® is a registered trademark of The Clorox Company.

**! NOTE !** Throughout this IFU “kVue Couch Top” refers to all kVue Couch Tops, including the kVue Calypso®, the kVue EDGE™, and the kVue Couch Top.

# TABLE OF CONTENTS

GENERAL PRECAUTIONS.....	4
WARNING STATEMENTS .....	4
SERIOUS INCIDENTS.....	4
COLLISION HAZARDS.....	4
WARNING LABELS & DESCRIPTIONS.....	5
INTENDED USE.....	7
FEATURES .....	8
DESCRIPTION .....	8
CALYPSO® COMPATIBLE SYSTEM.....	8
REQUIRED ACCESSORIES .....	8
COMPONENTS .....	9
OPERATING INSTRUCTIONS.....	12
INSTALLATION.....	12
SET-UP .....	13
REMOVAL.....	14
MAINTENANCE.....	15
CLEANING THE SYSTEM .....	15
CLEANING AND LUBRICATING PROCEDURE FOR ONETOUCH LATCH.....	16
SPECIFICATIONS.....	17
KVUE EDGE, KVUE CALYPSO COUCH TOP WITH STANDARD INSERT .....	17
PERFORMANCE .....	18
PARTS LIST .....	19
KVUE CALYPSO® COUCH TOP .....	19
KVUE EDGE™ COUCH TOP .....	19

# GENERAL PRECAUTIONS

## WARNING STATEMENTS

**! WARNING ! NO MODIFICATION OF THIS EQUIPMENT IS ALLOWED. IF ANY PART OF THIS DEVICE EXPERIENCES A CATASTROPHIC LOAD, APPEARS DAMAGED OR FUNCTIONS IMPROPERLY, DISCONTINUE USE IMMEDIATELY AND CONTACT QFIX AT +1 484-720-6054 OR TECHSUPPORT@QFIX.COM.**

**! WARNING ! THE ONETOUCH IS A PRECISION MECHANISM AND IS ONLY FOR USE WITH APPROVED QFIX KVUE DEVICES. UNAPPROVED NON-QFIX DEVICES THAT HAVE NOT BEEN VALIDATED BY QFIX MAY NOT BE SAFE FOR USE AND WILL VOID WARRANTY IF USED.**

## SERIOUS INCIDENTS

Please report any serious incidents (e.g. incidents which result in or have the potential to result in death or serious injury) to both Qfix and your country's Competent Authority.

## COLLISION HAZARDS

Use caution when moving the kVue Couch Top or gantry to avoid equipment damage or patient injury. The wide variety of motions obtainable with couch bases and treatment heads may present situations where the kVue Insert collides with other items. Equipment damage may occur.

# GENERAL PRECAUTIONS

## WARNING LABELS & DESCRIPTIONS

Refer to [Qfix.com](http://Qfix.com) for a listing of symbols and their definitions.

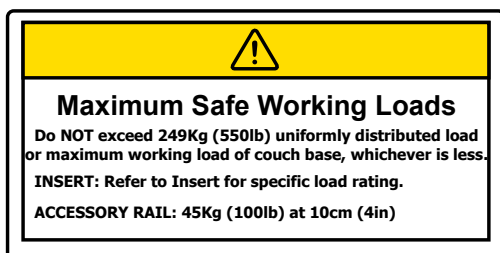

### LOAD RATING

DO NOT exceed 249 kg (550 lb) uniformly distributed load or maximum safe working load of couch base, whichever is less.

The load rating for each kVue Insert is specified in the instructions for the kVue Insert.

The accessory rail load rating is 45 kg (100 lb) at 10 cm (4 in.).

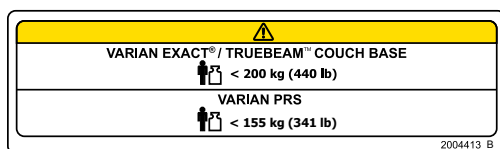

### LOAD RATING

DO NOT exceed 200 kg (440 lb) uniformly distributed load or maximum safe working load of couch base, whichever is less when using with the Varian Exact® or TrueBeam™ Couch Base.

DO NOT exceed 155 kg (341 lb) uniformly distributed load or maximum safe working load of couch base, whichever is less when using with the Varian PRS.

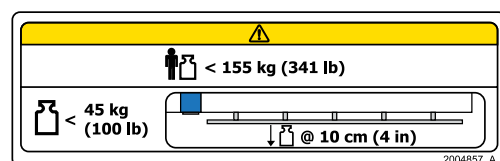

### LOAD RATING (FOR RT-4551KVE ONLY)

DO NOT exceed 155 kg (341 lb) uniformly distributed load or maximum safe working load of couch base, whichever is less.

The load rating for each kVue Insert is specified in the instructions for the kVue Insert.

The accessory rail load rating is 45 kg (100 lb) at 10 cm (4 in.).

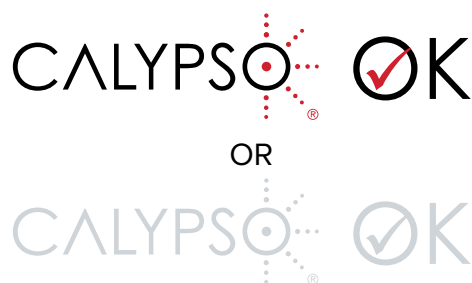

### CALYPSO® SYSTEM COMPATIBLE

Indicates Calypso® compatible when used with the kVue Calypso® or kVue EDGE™.

# GENERAL PRECAUTIONS

## WARNING LABELS & DESCRIPTIONS

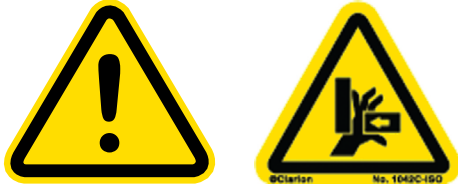

### PINCH POINTS

Use caution when moving the kVue Couch Top to avoid patient injury. Extreme care has been taken to minimize pinch points and other hazards associated with the kVue Couch Top. Common pinch points include:

- Between the kVue Insert and the One-Touch Latch
- Between the kVue Insert and the support beams
- Between the kVue Couch Top and other pieces of equipment in the treatment room, including the Linac treatment head

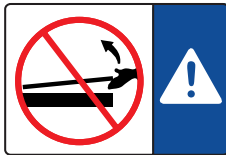

OR

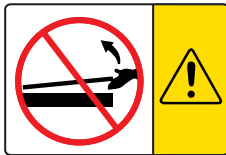

### KVUE INSERT INSTALLATION AND REMOVAL

**! WARNING ! NEVER LIFT THE END OF THE KVUE INSERT.**

The mating pins may bend or break, rendering the kVue Couch Top unusable.

Refer to the kVue Couch Top Installation Manual for installation and removal instructions.

↓ **NO STEP** ↓

OR



### “NO STEP” LINE

The yellow line on the kVue Insert represents the end of the support beams. The area beyond the line has been designed and tested to support the patient’s upper torso or lower body not exceeding the load rating.

Standing or sitting on the kVue Insert beyond the “No Step” line may damage the kVue Insert or cause injury.

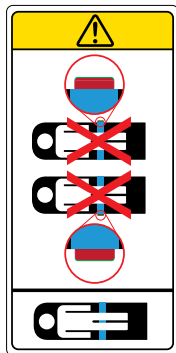

### ONETOUCH™ LATCH

Place a patient on the kVue Couch Top **ONLY** when the red collar of the latch button is not visible. The OneTouch Latch has a built-in indicator to verify proper engagement. If the red collar of the latch button is visible, the locking mechanism is not engaged.

# INTENDED USE

This device is intended to immobilize, position and reposition patients undergoing radiation therapy.

**! NOTE ! United States Federal law restricts this device to sale by or on the order of a physician.**

## **PATIENT TARGET GROUPS**

Patients undergoing radiation therapy or diagnostic imaging procedures.

## **INTENDED USERS**

The intended user for the products is a person qualified in accordance with the requirements of the regulatory region.

# FEATURES

## DESCRIPTION

The kVue Couch Top is state of the art radiotherapy coucht top optimized for the most recent advances in technology and designed to be compatible with the Calypso® System. It is engineered to ensure precise and repeatable sub-millimeter patient positioning. The kVue Calypso® & kVue EDGE™ are versions of the kVue product line. They are constructed from high strength advanced fiber composites that are completely metal free and non-conductive to enable its use with the Calypso® System. They add significant versatility to your treatment room and allows the use of most standard indexed positioning devices.

The kVue Couch Top is designed for superior performance when used with Kilovoltage imaging such as cone beam CT while simultaneously reducing skin dose for treatments that pass through the couch. This, combined with the ability to swap the Calypso® compatible Inserts for a wide range of kVue Inserts, makes the kVue Couch Top one of the most advanced solutions available for IMRT and IGRT patient positioning.

## CALYPSO® COMPATIBLE SYSTEM

The Calypso® system uses electromagnetic signals to detect the position of the implanted Beacon® electromagnetic transponders and localize the treatment target position during radiotherapy. System accuracy can be affected by conductive materials close to the Beacon transponders during localization.

Extensive testing has been performed to ensure that the kVue Calypso®, the kVue EDGE™ and all accessories labeled as Calypso® compatible are compatible with the kVue Couch Top. When using the Calypso® system, only Calypso® system compatible accessories should be used. Contact Varian for a list of compatible accessories.

## REQUIRED ACCESSORIES

kVue Insert (a Calypso® compatible Insert is required for use with the Calypso® system).



# FEATURES

## COMPONENTS

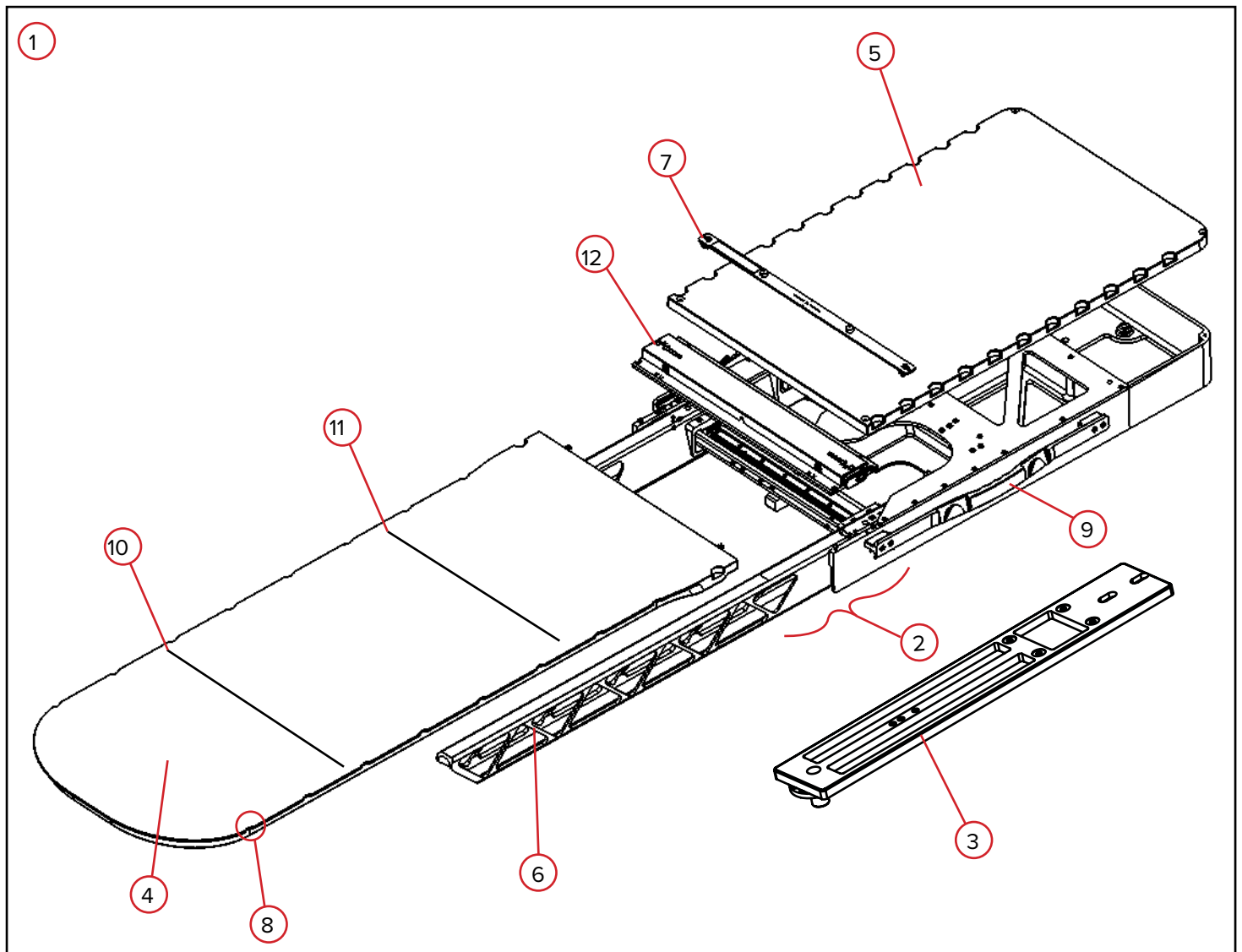

# FEATURES

## COMPONENTS

### 1. KVUE™ COUCH TOP

The kVue Couch Top is the complete patient support system, excluding the original equipment couch base. It consists of the Baseframe (including support beams), the Interface Plate (if required), and the appropriate kVue Insert.

### 2. BASEFRAME

The Baseframe is the section of the kVue Couch Top that contains the Moving Rails support beams and Back Panel. The Baseframe also has the receiving holes of the OneTouch Latch and the accessory rail.

### 3. INTERFACE PLATE

The Interface Plate is the interface between the linear accelerator manufacturer's couch base and the kVue Couch Top. No Interface Plate is required when mounting the kVue to the Varian EDGE™, TrueBeam™ or Exact® couch base.

### 4. KVUE INSERT

The kVue Insert is the treatment area of the patient support surface. It is constructed from low-density composite materials and will attenuate a 6 MV photon beam approximately 1% for AP/PA treatments. Treatment through any device will lead to higher skin dose, which should be considered during treatment planning. A Calypso® compatible Insert is required for use with the Calypso® system.

### 5. BACK PANEL

The Back Panel is the patient support surface that sits on top of the couch base.

### 6. MOVING RAILS SUPPORT BEAMS

The Moving Rails support beams are extremely rigid composite structures that support full patient loading on the kVue Insert with minimal deflection. The open truss design maximizes strength while minimizing attenuation. The support beams can be moved laterally with or without the patient on the kVue Couch Top.

Treatment through the support beams will lead to increased skin dose, which should be considered during treatment planning. Whenever possible, the support beams should be positioned so that they are not in the treatment beam path.

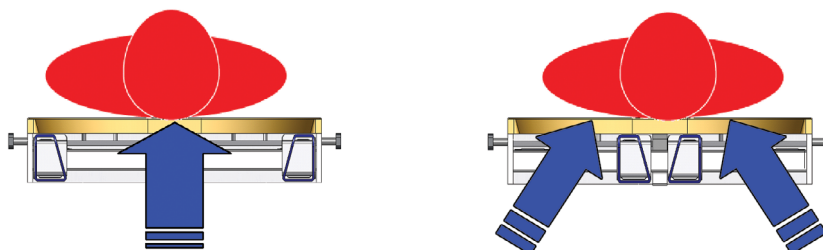

# FEATURES

## COMPONENTS

### 7. LOCATING BAR

The Locating Bar has two locating pins (13 mm (0.5-inch) diameter spaced 229 mm (9 inches) apart) designed to match industry-standard accessories that allow standard positioning devices to be accurately and repeatedly located on the kVue Couch Top. When using the Calypso® System, use only Calypso compatible accessories.

### 8. EXACT® INDEX NOTCHES

Varian Exact® compatible index notches are spaced every 140 mm along the length of the kVue Couch Top that can be used to accurately position the Locating Bar and other accessories. The numbering scheme of the notches coincides with Varian Exact® indexing to allow direct transfer of simulation positioning data to the kVue Couch Top. (The 0 marks the coordinate axis origin. H1, H2, etc., progress toward the head end of the kVue Couch Top and F1, F2, etc., progress toward the foot end.)

### 9. ACCESSORY RAIL

The accessory rail can be used to attach stirrups, IV poles, and other standard devices with commonly available clamps.

### 10. “NO STEP” LINE

Most kVue Inserts are marked with a yellow line that represents the end of the support beams. The Standard Insert is designed to support only the weight of the patient’s upper torso or lower body, not exceeding the load rating, beyond the “No Step” line. Standing or sitting on the kVue Insert beyond the “No Step” line may damage the kVue Insert or cause injury.

### 11. INFERIOR ISOCENTER LINE

The kVue Calypso® Insert is marked with a blue line that represents the furthest proximal location for the isocenter when using the Calypso® System. Contact your Varian Medical Systems Representative or refer to Calypso® System User’s Manual for more specific information about the importance of this line.

### 12. ONETOUCH LATCH

The OneTouch Latch allows instant attachment and removal of kVue Inserts without the use of tools. The latch allows repeatable positioning of the kVue Insert with sub-millimeter accuracy while simultaneously creating a visual cue to verify that the lock is properly engaged. In the unlocked position, a red collar is visible around the green latch button.

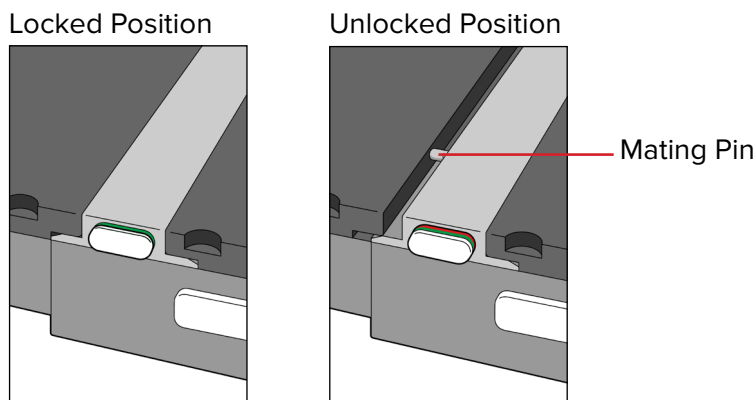

# OPERATING INSTRUCTIONS

## INSTALLATION

### KVUE COUCH TOP INSTALLATION

The kVue Couch Top is designed to fit all major radiotherapy treatment systems. Quick installation minimizes linear accelerator downtime during installation. Refer to the kVue Couch Top Installation Manual for specific installation information.

**! NOTE !** As detailed in the kVue Couch Top Installation Manual, the final height of the kVue surface may be different from the original system. Refer to the original system instructions to reset the system zero (origin) prior to initial use.

### KVUE INSERT INSTALLATION

1. Place the kVue Insert on top of the support beams and align the two mating pins with the receiving holes in the OneTouch Latch.
2. From the head end of the kVue, slide the kVue Insert directly into the receiving holes.

You will hear a click when the kVue Insert is locked into place. ONLY the green button surface will be visible when properly installed.

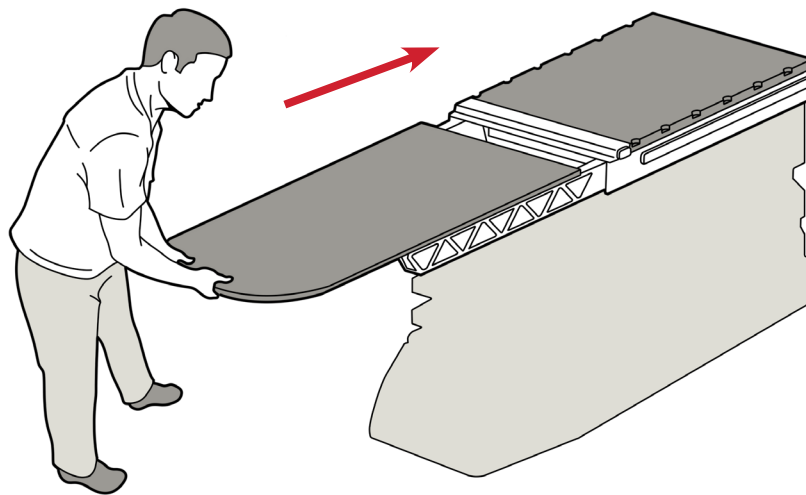

kVue with Standard Insert

# OPERATING INSTRUCTIONS

## SET-UP

### LOCATING BAR INSTALLATION

The Locating Bar has two locating pins that match most standard positioning accessories. To attach, place either end of the Locating Bar in the appropriate Varian Exact® compatible index notches and snap in place. When using the Calypso® System, use only Calypso compatible accessories.

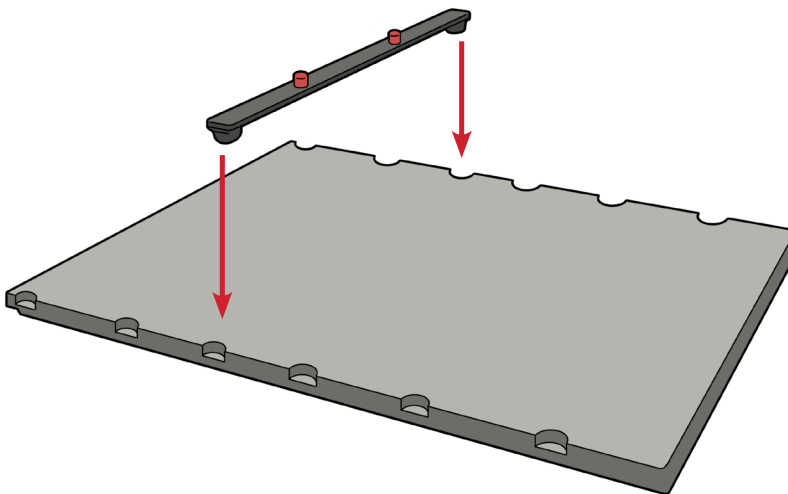

# OPERATING INSTRUCTIONS

## REMOVAL

### LOCATING BAR REMOVAL

Pull up on either end of the Locating Bar.

### KVUE INSERT REMOVAL

**! WARNING ! NEVER LIFT THE END OF THE KVUE INSERT ! ALTHOUGH THE MECHANISM IS VERY ROBUST, THE MATING PINS MAY BEND OR BREAK, RENDERING THE KVUE UNUSABLE.**

1. Rotate Lever counter-clockwise.
2. Pull the rotated Lever from one side of the kVue until the kVue Insert is released.
3. Slide the kVue Insert away from the kVue.

**! NOTE !** The images shown below are of a standard kVue Couch Top. kVue Insert removal is the same for all versions of the kVue.

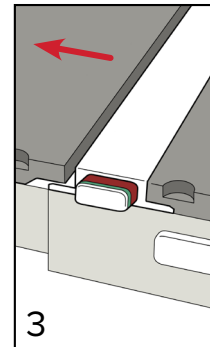
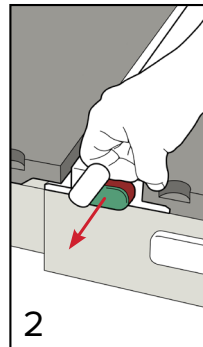
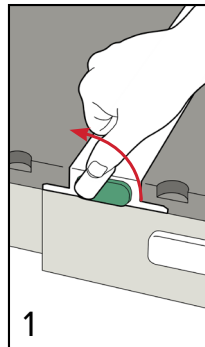
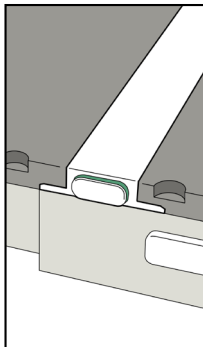

# MAINTENANCE

## CLEANING THE SYSTEM

The device can be cleaned with a mild, non-abrasive cleaning or disinfecting solution. Do not spray or pour liquids onto the kVue Couch Top surface as they may flow into the OneTouch Latch or mechanisms within the couch base. To clean, apply solution to clean cloth and wipe the surface.

The following cleaning materials have been tested and found to be appropriate for cleaning the kVue Couch Top surface. To disinfect the kVue Couch Top surface, refer to specific instructions from the cleaning agent manufacturer.

- Water
- A 10% Clorox® Bleach Solution
- Isopropyl Alcohol
- Cidex® 2.4% Activated Dialdehyde Solution
- Soap and Water

DO NOT spray directly onto the kVue Couch Top or allow to flow into the Baseframe.

DO NOT place sharp objects on the kVue Couch Top.

If body fluids enter the Baseframe, remove the screws that connect the Back Panel and clean appropriately. Do not use any water-based cleaners on the linear bearing rail. After cleaning, lubricate the linear bearing rail with fluoropolymer (PTFE) dry film lubricant.

The OneTouch Latch requires periodic lubrication; refer to specific instructions on how to properly lubricate and clean the OneTouch Latch.

Disassembly of the OneTouch Latch will void the kVue Couch Top warranty.

Periodically check all fasteners for tightness.

# MAINTENANCE

## CLEANING AND LUBRICATING PROCEDURE FOR ONETOUCH LATCH

We recommend performing this procedure monthly.

Materials List: fluoropolymer (PTFE) dry film lubricant, cotton swabs, and dry wipes or paper towels

**! NOTE !** The images shown below are of a standard kVue Couch Top. Maintenance is the same for every kVue Couch Top.

1. Remove kVue Insert. (Fig.1)
2. Wipe any lint or debris from the outside of latch. (Fig. 2)
3. Use dry cotton swab to clean out the inside of the receiving holes. (Fig. 3)
4. Spray lubricant into the receiving holes. (Fig. 4)
5. Use dry cotton swab to wipe out loose lint and debris. (Fig. 3)
6. Spray lubricant into the receiving holes again. (Fig. 4)
7. Spray lubricant into the gap between the top of the button and the latch housing to lubricate interior components. (Fig. 5)
8. Reinsert the kVue Insert and eject by pulling latch from opposite side. Repeat lubrication step 7.
9. Cycle kVue Insert installation and removal 3 to 4 times and repeat lubrication process if Insert does not eject freely.
10. Wipe off any excess lubricant from the exterior of the OneTouch Latch.

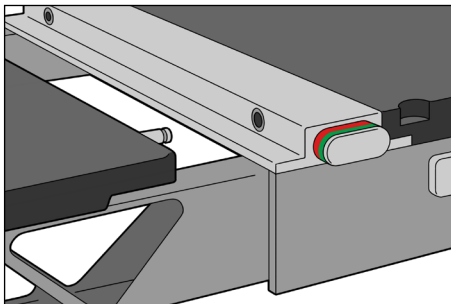

Fig. 1

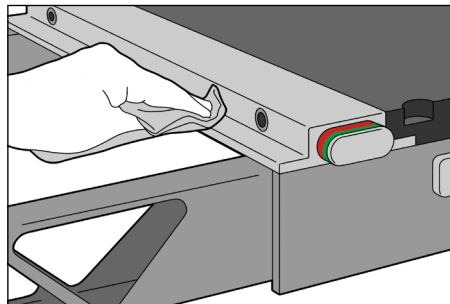

Fig. 2

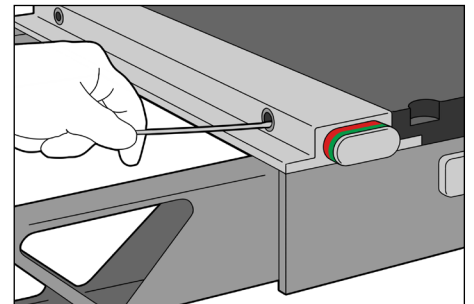

Fig. 3

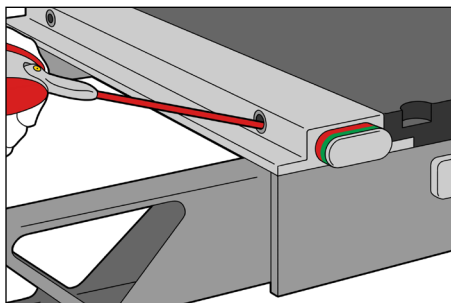

Fig. 4

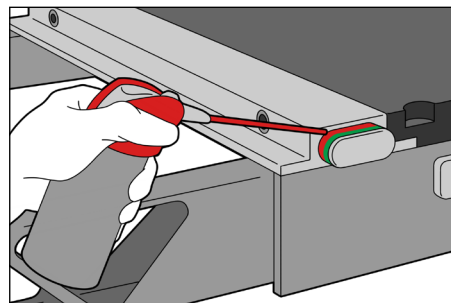
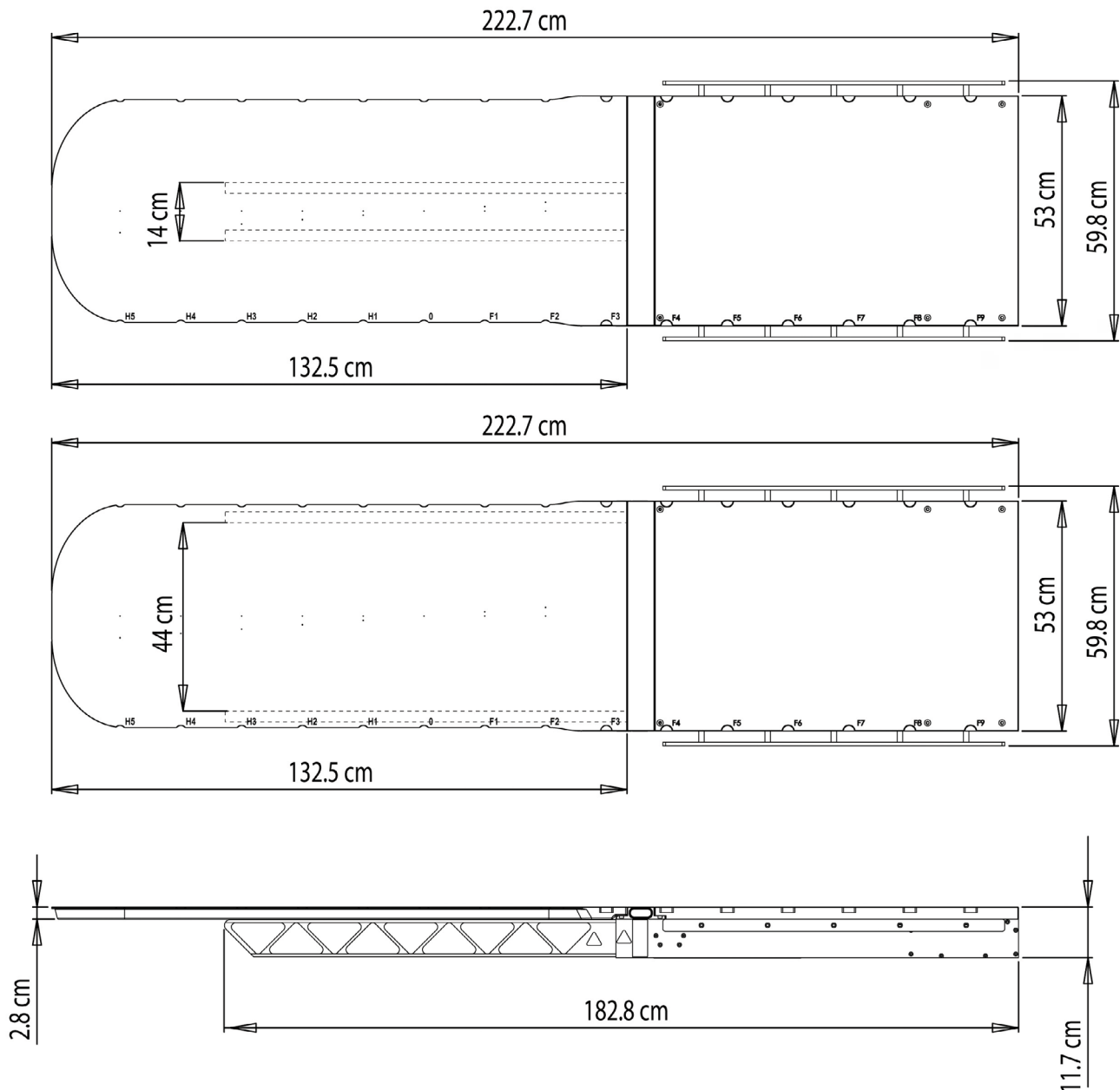

Fig. 5



# SPECIFICATIONS

## KVUE EDGE, KVUE CALYPSO COUCH TOP WITH STANDARD INSERT



**! NOTE !** For specifications pertaining to individual kVue Inserts, refer to the particular kVue Insert IFU.

# SPECIFICATIONS

## PERFORMANCE

### DEFLECTION

The kVue Couch Top meets the deflection specification of IEC 60976 [2007] Section 16.5.2.2. The height of the kVue Couch Top retracted and with a load of 30 kg distributed over 1 m is within 5 mm of the height of the kVue Couch Top extended with 135 kg distributed over 2 m of the kVue length.

### LOAD RATING AND CAPACITY

The kVue Couch Top meets the load rating requirements of IEC 60601-2-8 Clause 28 with a safe working load specified in individual kVue Insert instructions.

In no case should the capacity of the kVue Couch Top exceed the manufacturer's original couch base specifications.

Some kVue Inserts have a load rating lower than 249 kg. Refer to the kVue Insert IFU or kVue Insert product label for specific load ratings.

# PARTS LIST

## KVUE CALYPSO® COUCH TOP

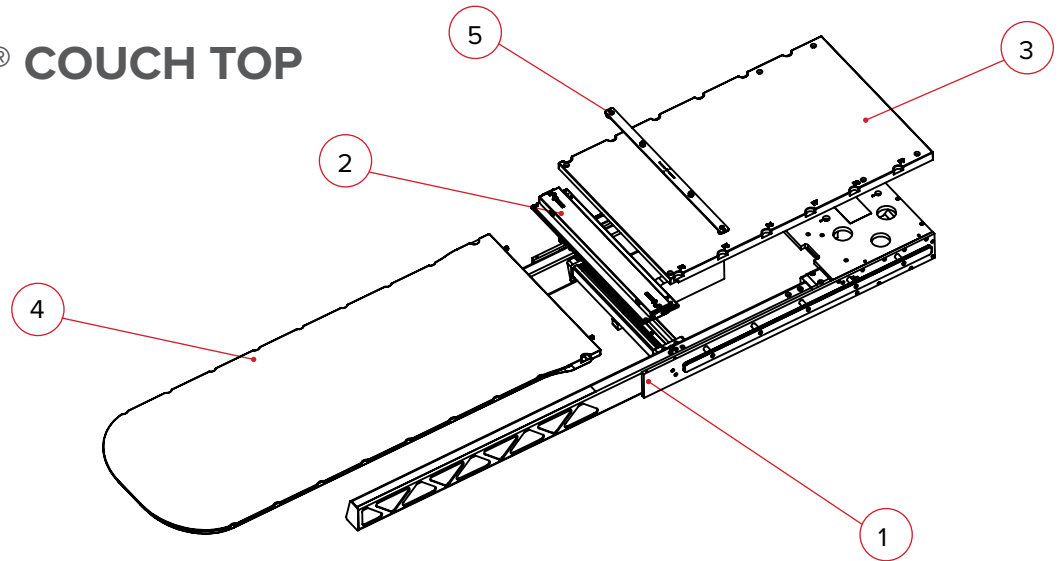

1. RT-4551KVCL-V – kVue Calypso® Baseframe, with Varian Exact® Indexing
2. RT-4551KV-OTM – kVue OneTouch™ Latch Assembly
3. RT-4551KV0CL-V – kVue Calypso® Back Panel, with Varian Exact® Indexing
4. RT-4551KV11 – kVue Calypso® Insert, Varian Compatible
5. RT-4551BAR-02 – Calypso® Compatible Locating Bar, Varian Exact® Indexing
6. RT-4551BAR-02-01 – Varian Hardware Kit (not shown in diagram)
7. RT-4551KVPP – kVue Pinch Point Cover Kit (not shown in diagram)
8. 8002064 – kVue Calypso® Replacement Beam Set

## KVUE EDGE™ COUCH TOP

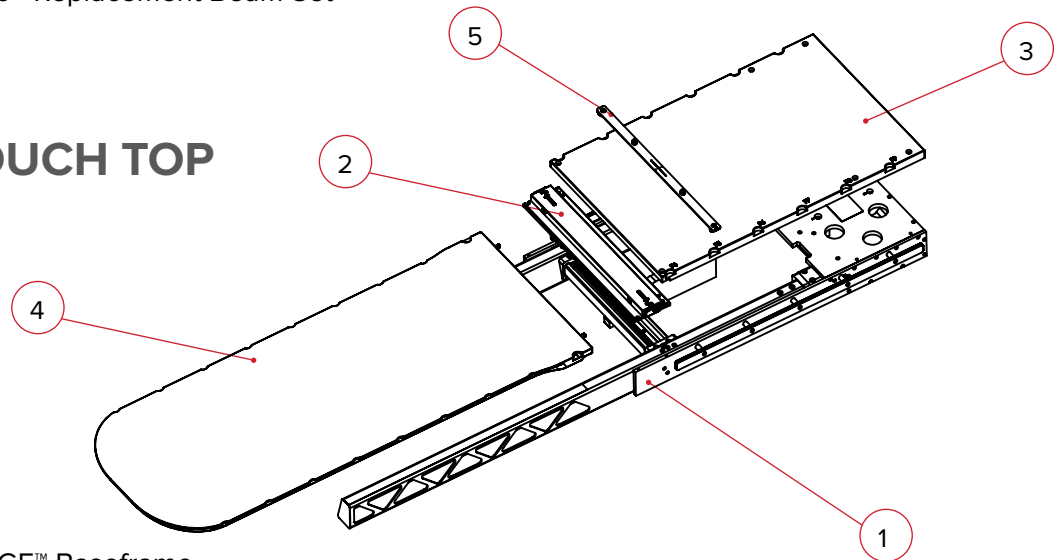

1. RT-4551KVE – kVue EDGE™ Baseframe
2. RT-4551KV-OTM – kVue OneTouch™ Latch Assembly
3. RT-4551KV0-E – kVue EDGE™ Back Panel
4. RT-4551KV12 – kVue EDGE™ Insert
5. RT-4551BAR-02 – Calypso® Compatible Locating Bar, Varian Exact® Indexing
6. RT-4551BAR-02-01 – Varian Hardware Kit (not shown in diagram)
7. RT-4551KVPP – kVue Pinch Point Cover Kit (not shown in diagram)
8. RT-4551KV-PRS01 – kVue Alignment Jig, Varian PRS
9. 8002110 – kVue EDGE Replacement Beam Set



440 Church Road  
Avondale, PA 19311 USA  
[www.Qfix.com](http://www.Qfix.com)

+1 610.268.0585 / 800.526.5247

+1 610.268.0588 / 800.831.8174

[sales@Qfix.com](mailto:sales@Qfix.com)

2004858\_EN\_K  
2020-06