



# PRODUCT GUIDE & USER MANUAL

8002041

8002066

8002067

X-Trans™ Armboard



<div>EC</div> <div>REP</div>		Advena Limited Tower Business Centre, 2nd Flr Tower Street, Swatar, BKR 4013 Malta	 Made in the USA Qfix 440 Church Rd, Avondale, Pennsylvania, USA +1 712-737-8668 <a href="http://www.CQmedical.com">www.CQmedical.com</a>
------------------------------	--	---	---

X-Trans™ is a trademark of CQ Medical.

Cidex® is a registered trademark of Johnson & Johnson.

Clorox® is a registered trademark of The Clorox Company.

# TABLE OF CONTENTS

GENERAL PRECAUTIONS.....	4
WARNING STATEMENTS .....	4
SERIOUS INCIDENTS.....	4
LOAD RATING .....	4
WARNING LABELS & DESCRIPTIONS.....	4
INTENDED USE.....	5
MAINTENANCE.....	6
CLEANING THE SYSTEM .....	6
DISINFECTING THE SYSTEM.....	6
PARTS LIST .....	7
8002065 (A) .....	7
8002068 (B) .....	7
OPERATING INSTRUCTIONS.....	8
INSTALLATION.....	8
REMOVAL.....	10

# GENERAL PRECAUTIONS

## WARNING STATEMENTS

**! WARNING ! NO MODIFICATION OF THIS EQUIPMENT IS ALLOWED. IF ANY PART OF THIS DEVICE EXPERIENCES A CATASTROPHIC LOAD, APPEARS DAMAGED OR FUNCTIONS IMPROPERLY, DISCONTINUE USE IMMEDIATELY AND CONTACT CQ MEDICAL AT +1 712-737-8668 OR [INFO@CQMEDICAL.COM](mailto:INFO@CQMEDICAL.COM).**

## SERIOUS INCIDENTS

Please report any serious incidents (e.g. incidents which result in or have the potential to result in death or serious injury) to both CQ Medical and your country's Competent Authority.

## LOAD RATING

8002041—DO NOT exceed 249 kg (550 lb) uniformly distributed load

8002066—DO NOT exceed 226 kg (500 lb) uniformly distributed load

8002067—DO NOT exceed 226 kg (500 lb) uniformly distributed load

## WARNING LABELS & DESCRIPTIONS

Refer to [www.CQmedical.com](http://www.CQmedical.com) for a listing of symbols and their definitions.

# INTENDED USE

This family of products is designed as radiolucent devices used for injections and/or armrests. The products are designed to be used with flat top Angiography tables and flat top imaging tables.

**! NOTE ! United States Federal law restricts this device to sale by or on the order of a physician.**

## **PATIENT TARGET GROUPS**

Patients undergoing general medical or surgical procedures involving diagnostic imaging.

## **INTENDED USERS**

The intended user for the products is a person qualified in accordance with the requirements of the regulatory region.

# MAINTENANCE

## CLEANING THE SYSTEM

The device can be cleaned with a mild, non-abrasive cleaning or disinfecting solution. To clean, apply solution to clean cloth and wipe the surface.

## DISINFECTING THE SYSTEM

The following cleaning materials have been tested and found to be appropriate for cleaning the device surface. To disinfect the device surface, refer to specific instructions from the cleaning agent manufacturer.

- Water
- A 10% Clorox® Bleach Solution
- Isopropyl Alcohol
- Cidex® 2.4% Activated Dialdehyde Solution
- Soap and Water

Periodically check all fasteners for tightness.

# PARTS LIST

## 8002065 (A)

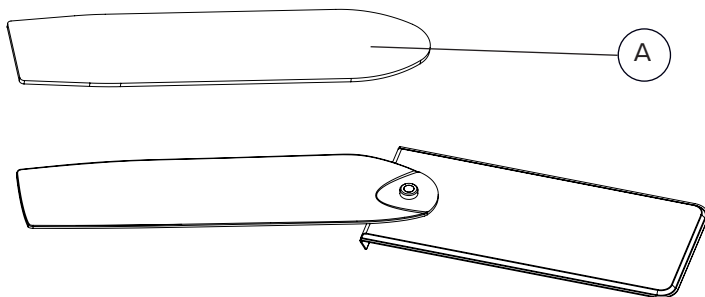

## 8002068 (B)

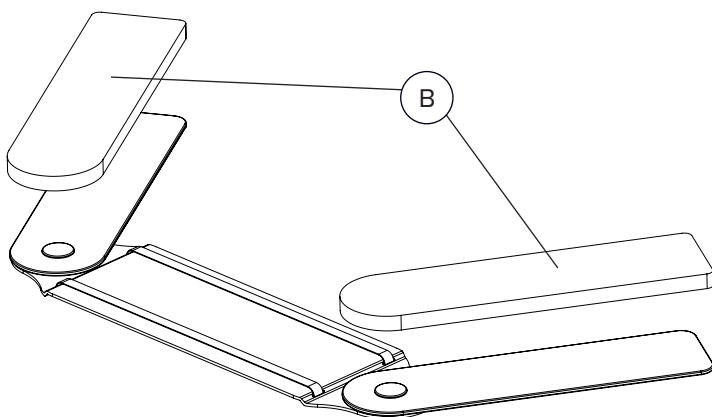

# OPERATING INSTRUCTIONS

## INSTALLATION

8002041

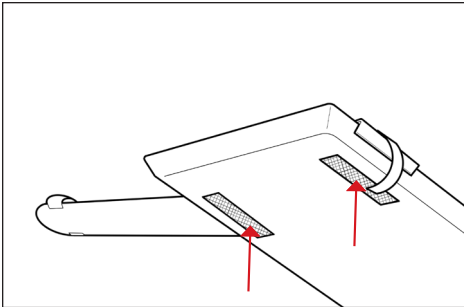

1

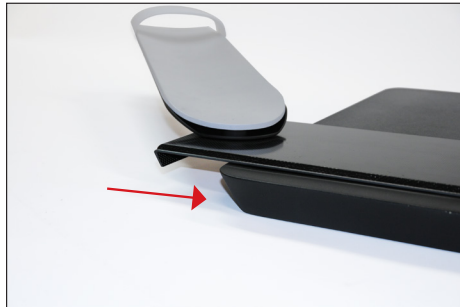

2



3



4



5



6



7



# OPERATING INSTRUCTIONS

## INSTALLATION

8002066 & 8002067



8



9

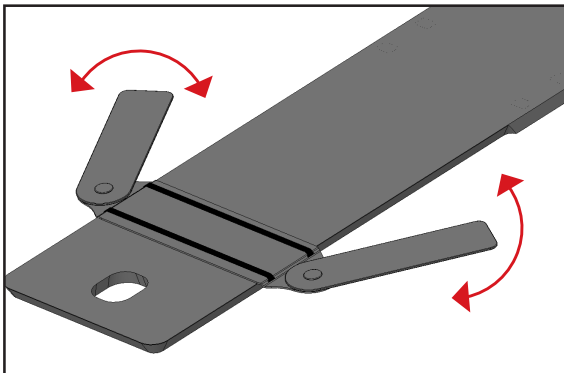

10

# OPERATING INSTRUCTIONS

## REMOVAL

8002041

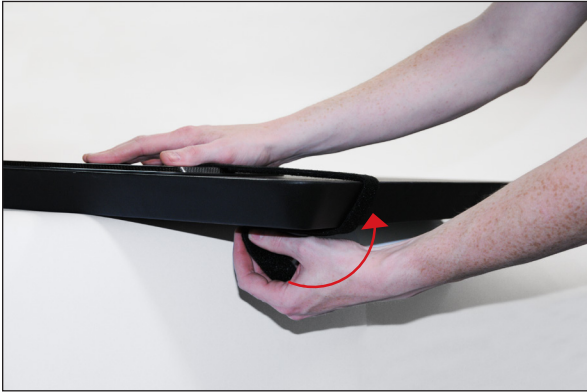

11

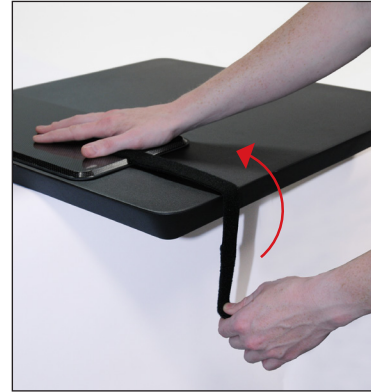

12

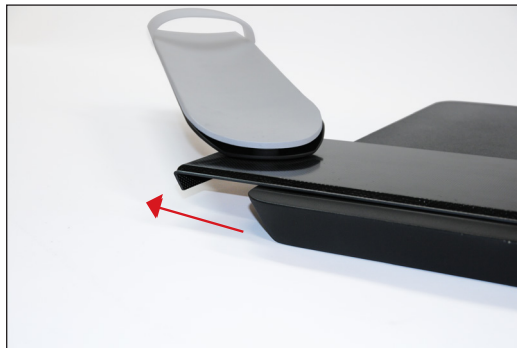

13

# OPERATING INSTRUCTIONS

## REMOVAL

8002066 & 8002067



14



15



440 Church Road  
Avondale, PA 19311 USA  
[www.CQmedical.com](http://www.CQmedical.com)

☎ +1 712.737.8668 / 800.842.8688  
✉ [info@CQmedical.com](mailto:info@CQmedical.com)

2004706\_EN\_1  
2024-12