

Edge Guide System

For use with Lithotomy Air Shuttle

INSTRUCTIONS FOR USE (IFU)

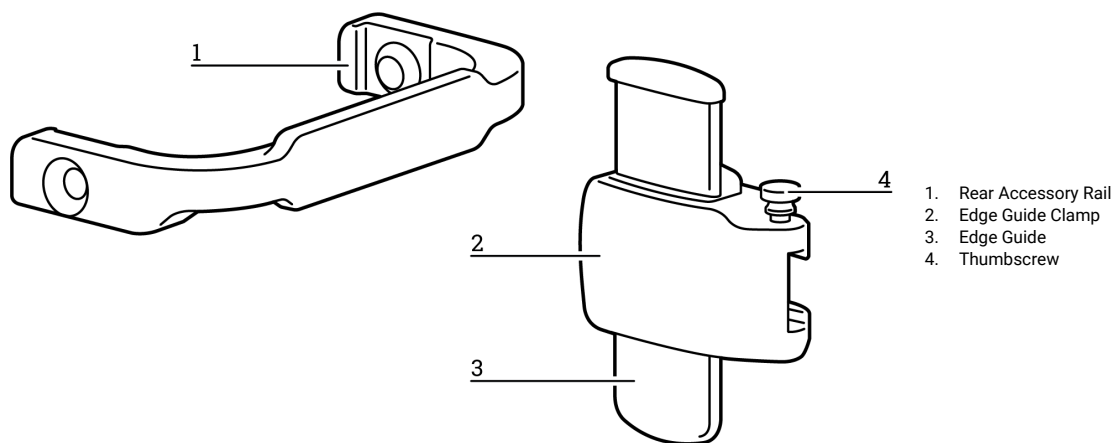



PARTS LIST	
2009541	Rear Accessory Rail
2009561	Edge Guide Clamp
2009562	Edge Guide
3002735	Thumbscrew

INTENDED USE

The Symphony® Patient Transport System is indicated to aid in the support, positioning, and transfer of a patient for procedures involving imaging, including MRI; and external beam radiation therapy treatment with electrons, photons or protons; and other procedures requiring transfer of a patient. The Symphony® is designed to interface with other positioning devices, such as couchtops, inserts, thermoplastic masks, and positioning pads.

CAUTION

Federal (United States) law restricts this device to sale by or on the order of a physician.

⚠ WARNING

- No modification of this equipment is allowed. If any part of this device experiences a catastrophic load, appears damaged or functions improperly, discontinue use immediately and contact CQ Medical at info@CQmedical.com.
- Only use CQ Medical compatible accessories.
- Do not allow patient to reposition themselves using accessories.
- Ensure device is secure prior to use.
- Ensure Edge Guides are deployed during patient loading and unloading.

NOTE: If any serious incident occurs in relation to device, incident should be reported to manufacturer. If incident occurred within the European Union, also report to the competent authority of the Member State in which you are established.

MRI SAFETY INFORMATION



MR Safe

- Device is MR safe.

REAR ACCESSORY RAILS INSTALLATION

1. Using hexagonal key, remove screws securing head handles (2 screws on each side). Keep screws for Step 3.

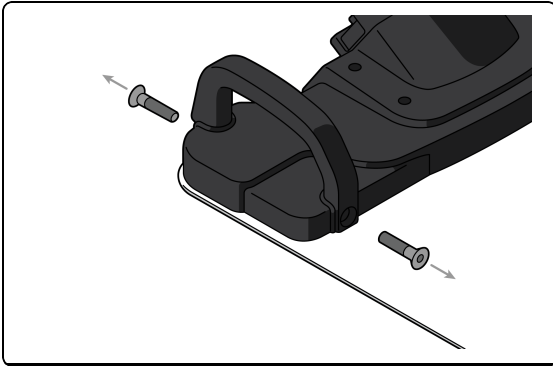

2. Clamp Rear Accessory Rail over handle.

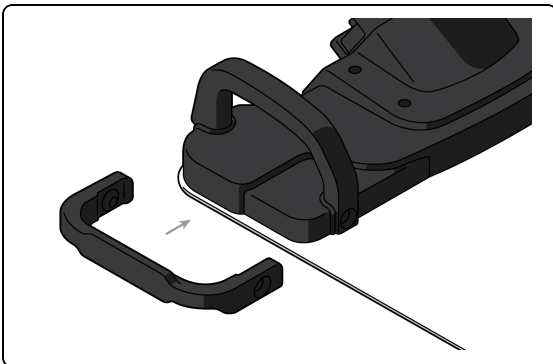

3. Reinstall screws to secure handle and rail. Tighten screws until handle and rail are securely attached

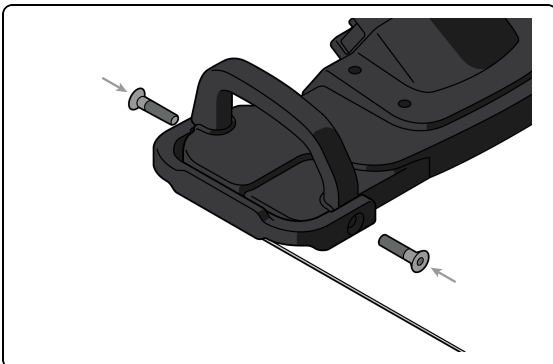

⚠ WARNING

- Do not overtighten.

EDGE GUIDE INSTALLATION

1. Slide Edge Guides to desired location on rail.
2. Secure Guides using thumbscrew.

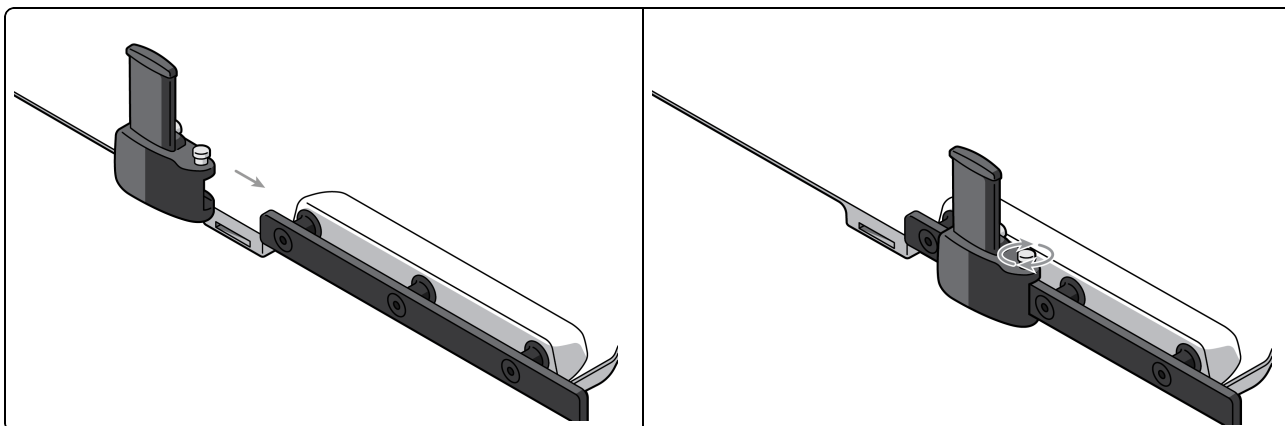
**USING EDGE GUIDE**

NOTE: When performing longitudinal transfer, deploy the Edge Guide as below for additional aid.

1. To deploy Edge Guide, unscrew thumbscrew and push Guide down.
2. To retract Edge Guide, push Guide up and tighten thumbscrew to secure.

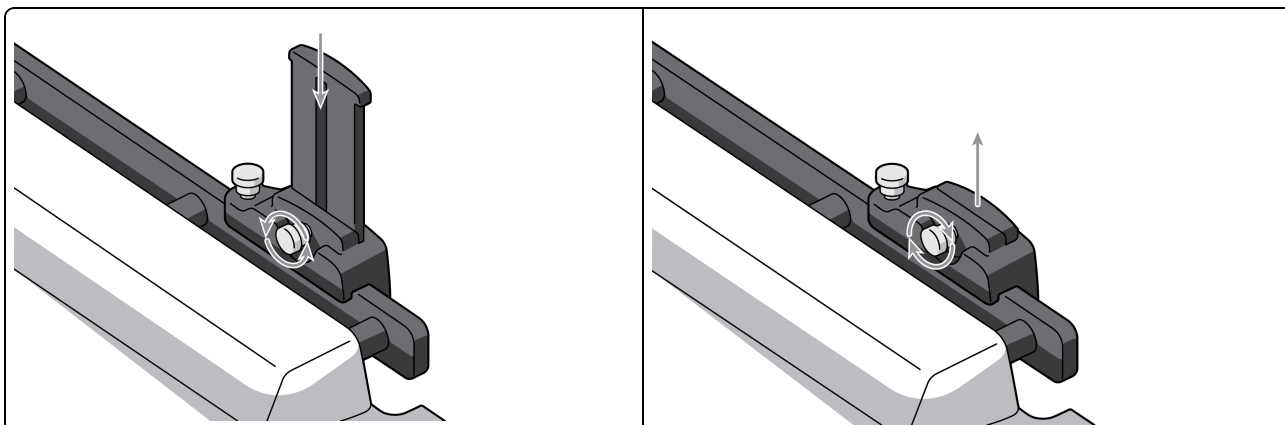
**⚠ WARNING**

- Retract Edge Guides when not performing a longitudinal transfer.

REPROCESSING**⚠ WARNING**

- Users of this product have an obligation and responsibility to provide the highest degree of infection control to patients, co-workers and themselves. To avoid cross-contamination, follow infection control policies established by your facility.

1. If necessary, clean surface by removing visual contamination with 70% alcohol or Theracide (PDI Sani-Cloth Plus) wipes. If visual contamination cannot be removed, repeat cleaning steps and if necessary, discard device.

MAINTENANCE

NOTE: Inspect device prior to use for signs of damage and general wear.



Advena Limited
Tower Business Centre, 2nd Flr
Tower Street, Swatar BKR 4013
Malta



 QFix
440 Church Rd
Avondale, Pennsylvania
United States
info@cqmedical.com

COPYRIGHT © 2025 ALL RIGHTS RESERVED. CQ MEDICAL IS A TRADEMARK OF MEDTEC LLC. SYMPHONY IS A REGISTERED TRADEMARK OF QFIX. ALL OTHER TRADEMARKS ARE PROPERTY OF THEIR RESPECTIVE OWNERS. PRINTED IN USA.

www.CQmedical.com