

Universal Couchtop™ Long Extension Storage Rack

INSTRUCTIONS FOR USE (IFU)



INTENDED USE

The device is intended for storage of CQ Medical medical devices.

⚠ WARNING

- Do not use if device appears damaged.
- Do not store items other than Universal Couchtop™ Long Extensions on the storage rack.

NOTE: If any serious incident occurs in relation to device, incident should be reported to manufacturer. If incident occurred within the European Union, also report to the competent authority of the Member State in which you are established.

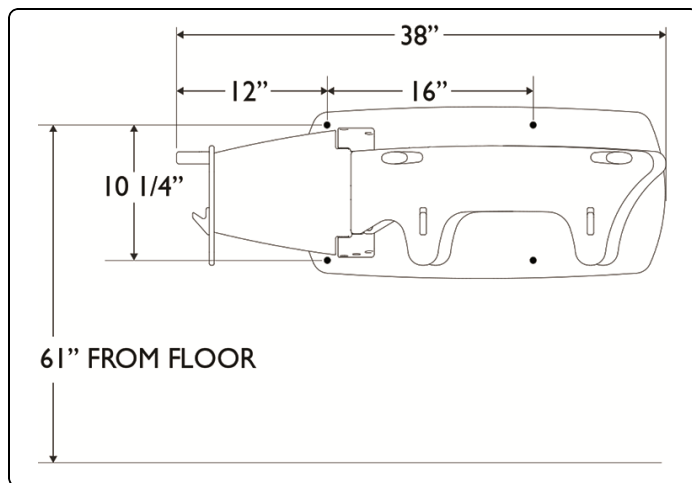
FIGURE 1**MOUNTING STORAGE RACK**

PRIOR TO USE:

- If desired, storage rack may be configured to have hinge on right hand side. See section "Changing Hinge Orientation" for instructions.
- Ensure adequate space for operation of hinge arms (See figure 1).
- Suggested height will provide approximately 4" of clearance off floor when hanging longest extension on rack.

CONCRETE WALL

NOTE: Tools Required: 5/16" masonry drill bit, 3/16" masonry drill bit, 1/2" socket, 9/64 Hex wrench, hammer and #3 phillips screw driver (not provided).

1. Drill four (4) 5/16" diameter pilot holes into concrete wall at locations specified. (See figure 1).
2. Support storage rack and align holes in wall plate with drilled pilot holes.
3. Mount storage rack to wall using four (4) concrete anchors (provided).
4. Ensure storage device is securely attached to wall.

WOOD STUD WALL

NOTE:

- Storage rack must be mounted onto 16" on-center studs.
- Tools Required: 15/64" drill bit, 1/8" drill bit, 1/2" socket, 9/64 Hex wrench and #3 phillips screw driver (not provided).

1. Drill four (4) 15/64" diameter pilot holes into wall studs at locations specified. (See figure 1).
2. Mount storage rack to wall using four (4) lag screws (provided).
3. Ensure storage device is securely attached to wall.

STEEL STUD WALL

NOTE:

- Storage rack must be mounted onto 16" on-center studs.
- Tools Required: 1/2" drill bit, 1/8" drill bit, 3/16 Hex wrench and #3 phillips screw driver (not provided).

1. Drill four (4) 1/2" diameter pilot holes into wall studs at locations specified. (See figure 1).
2. Install toggle anchors:

- Hold metal channel flat alongside plastic straps, slide channel through pilot hole.

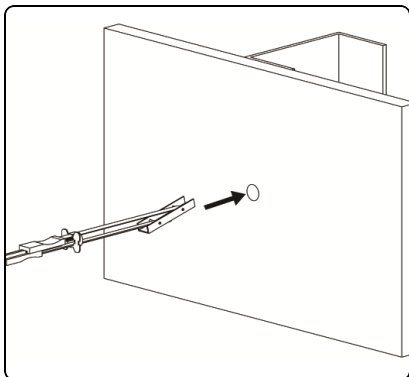

- Hold ends of straps between thumb and forefinger, pull until channel rests flush behind wall. Strap ends will be even lengths when channel is flush. Slide plastic cap along straps into pilot hole until flange of cap is flush with wall.

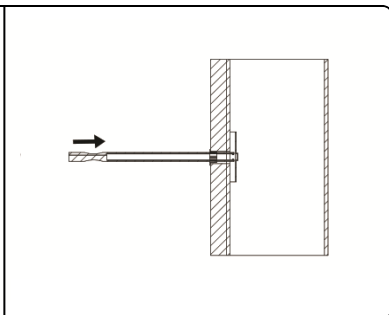
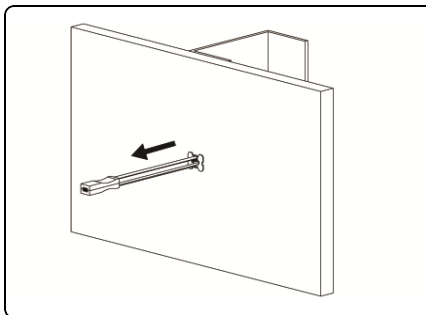

- Snap off straps flush with flange of cap and discard.

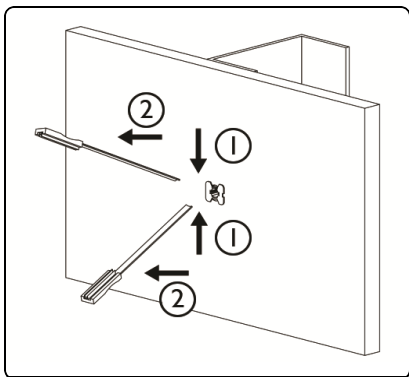

3. Mount storage rack to wall using four (4) 1/4-20 screws and washers (*provided*).
4. Ensure storage device is securely attached to wall.

INSTALLING BOLT COVERS AND WALL GUARDS

1. Use two (2) #8 cap screws (*provided*) to secure bolt covers over wall plate fasteners (4).

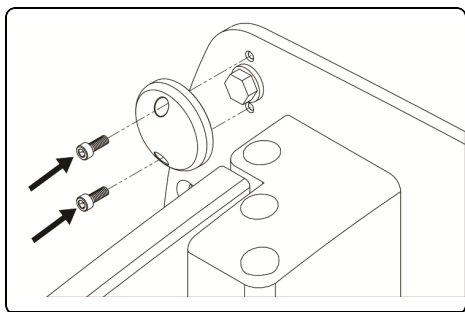

NOTE: Wall guards protect Varian Extension (MTIL6667) and wall from damage.

2. Drill two (2) 1/8" diameter pilot holes for wood stud and steel stud walls (3/16" for concrete walls) into wall at locations specified.

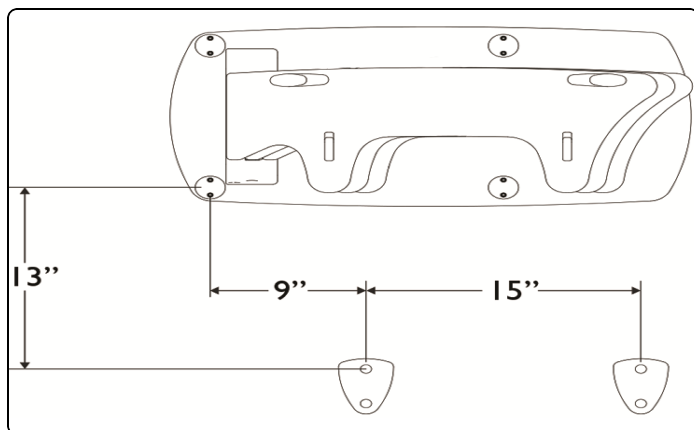

3. Insert two (2) #14 screws thru top hole of wall guards into pilot holes.
4. Drill two (2) pilot holes in bottom hole location and insert two (2) remaining #14 screws.

USING STORAGE RACK

NOTE: Each extension will hang on storage rack hooks using round slots in backside of junction.

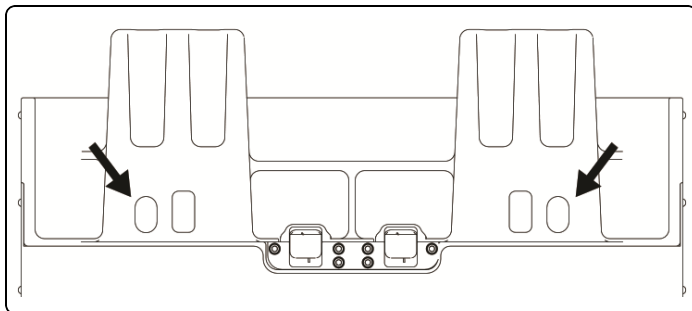

NOTE: To avoid damage, hang Varian Extension (MTIL6667) behind other extensions.

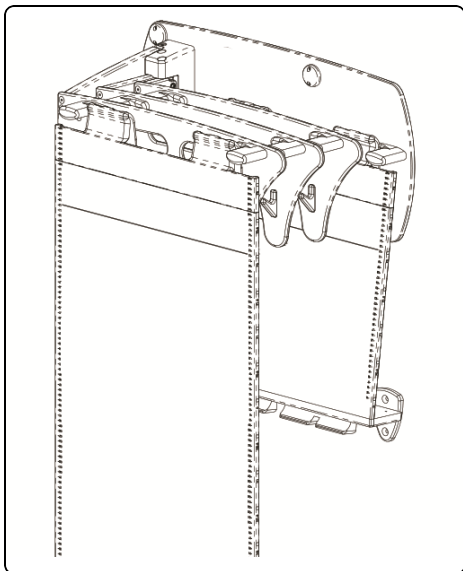

1. Center extension forks between two outer stops and hang on hooks.

CHANGING HINGE ORIENTATION (OPTIONAL)

NOTE: Tools Required: 9/64, 3/16, 5/32 Hex wrenches and #3 phillips screw driver (*not provided*).

1. Remove outer stops (8) and hooks (8) from crossbars and wall plate. Re-attach to opposite side.

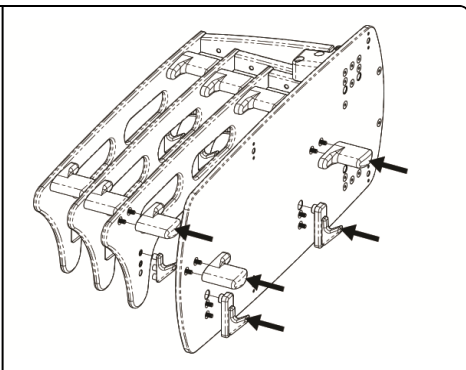
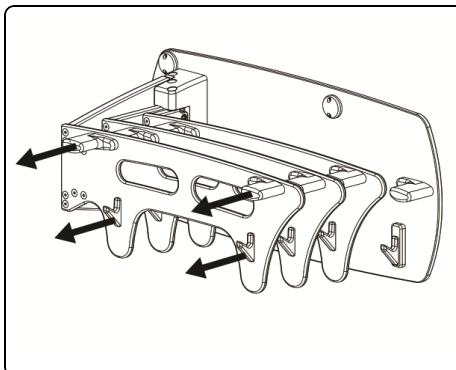

2. Remove rubber (2) bumpers, re-attach to opposite side.

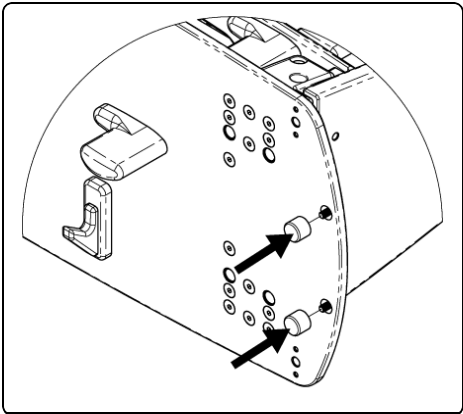

3. Remove gussets (6) from crossbars, set aside crossbars and gussets.

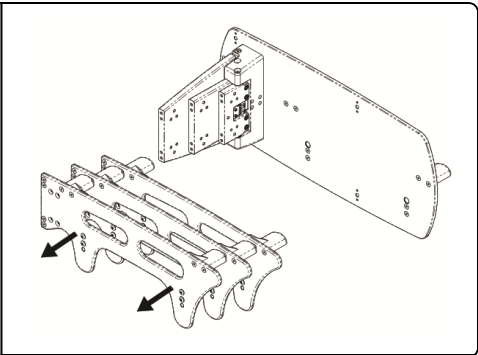
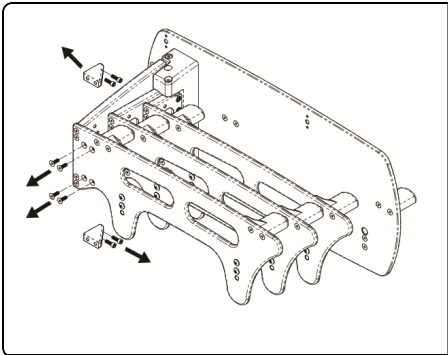

4. Remove full hinge assembly, re-attach to opposite side.

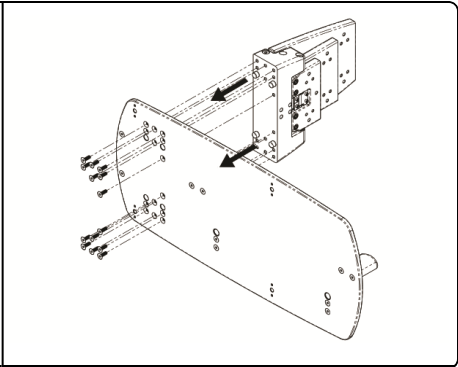
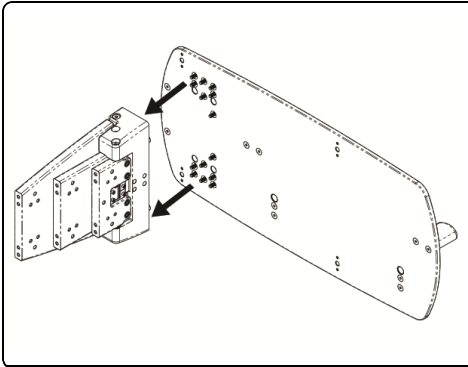

5. Re-attach crossbars and gussets.

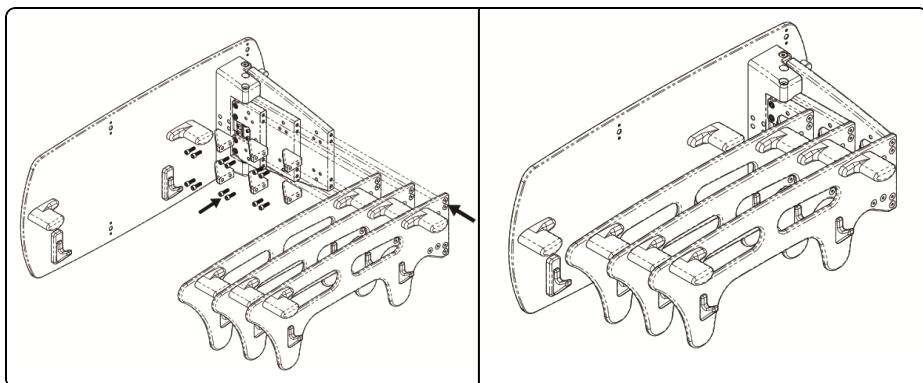

REPROCESSING



WARNING

- *Users of this product have an obligation and responsibility to provide the highest degree of infection control to patients, co-workers and themselves. To avoid cross-contamination, follow infection control policies established by your facility.*

1. Clean device with a mild, non-abrasive cleaner as needed.

MAINTENANCE

NOTE: Inspect device prior to use for signs of damage and general wear.



 **MEDTEC LLC**

1401 8th Street SE
Orange City, IA 51041
United States

800.842.8688, +1 712.737.8688
info@cqmedical.com

COPYRIGHT © 2024 ALL RIGHTS RESERVED. CQ MEDICAL IS A TRADEMARK OF MEDTEC LLC. UNIVERSAL COUCHTOP IS A TRADEMARK OF MEDTEC LLC. ALL OTHER TRADEMARKS ARE PROPERTY OF THEIR RESPECTIVE OWNERS. PRINTED IN USA.

www.CQmedical.com